

DATA SHEET – HORIZONTAL – CONTROLS GROUPED (HZ-CG)

PRODUCT CODE(S): 35023

UNICLASS: L4231

EPIC: D25

VERSION: Issue L – March 2022



HORIZONTAL – CONTROLS GROUPED (HZ-CG)

PRODUCT DESCRIPTION

The HZ-CG system is used for Smoke / Fire Curtains fitted with 24Vdc permanent magnet electrical motors fitted with an internal 24Vdc electromagnetic brake, as standard. When the Smoke / Fire curtain(s) is fully retracted, the internal electromagnetic brake is powered, keeping the Smoke / Fire curtain(s) in the retracted position. Power to the motor is completely isolated, prolonging the life of the motor and maintaining manufacturers supply warranty.

OPERATION

In the event of an alarm signal the curtain will close immediately to the Fire Operational Position (FOP). If there is a mains power failure the curtain will remain in the open position for approximately 30 minutes as standard, (but can be increased if required) before closing to the Fire Operational Position (FOP). If an alarm signal is received during a mains power failure, the curtain will close immediately to the Fire Operational Position (FOP).

The HZ-CG includes the battery back-up facility. The Battery Back-Up facility is provided by two 12Ah 12V batteries which are constantly charged by the HZ-CG.

The HZ-CG includes the integrated Zone Control Panel (ZCP).

SPECIFICATION

Power Input:

220-240Vac 50H/60z dedicated supply

Power Rating (Maximum):

ERU-CG SIMPLEX	300 Watts
ERU-CG DUPLEX	450 Watts

Power Rating (Nominal):

ERU-CG SIMPLEX	30 Watts
ERU-CG DUPLEX	40 Watts

Alarm Input:

Normally closed contact from fire alarm.
Open on alarm activation.

Outputs:

24V DC to the Motor

Material:

Mild Steel

Finish:

RAL 7035 (Light Grey)

Dimensions (mm):

Simplex
500(h) x 400(w) x 210(d)

Duplex
600(h) x 600(w) x 210(d)

Weight:

Simplex
15.2kg

Duplex
25.1kg

IP Rating:

IP55

Temperature Range:

0°C to +50°C

Location:

Internal

HORIZONTAL – CONTROLS GROUPED (HZ-CG)

VARIOSPEED®6 CONTROLS GROUPED (CG) –
TYPICAL WIRING LAYOUT FOR
SIMPLEX™ (SINGLE BARRIER ASSEMBLY)

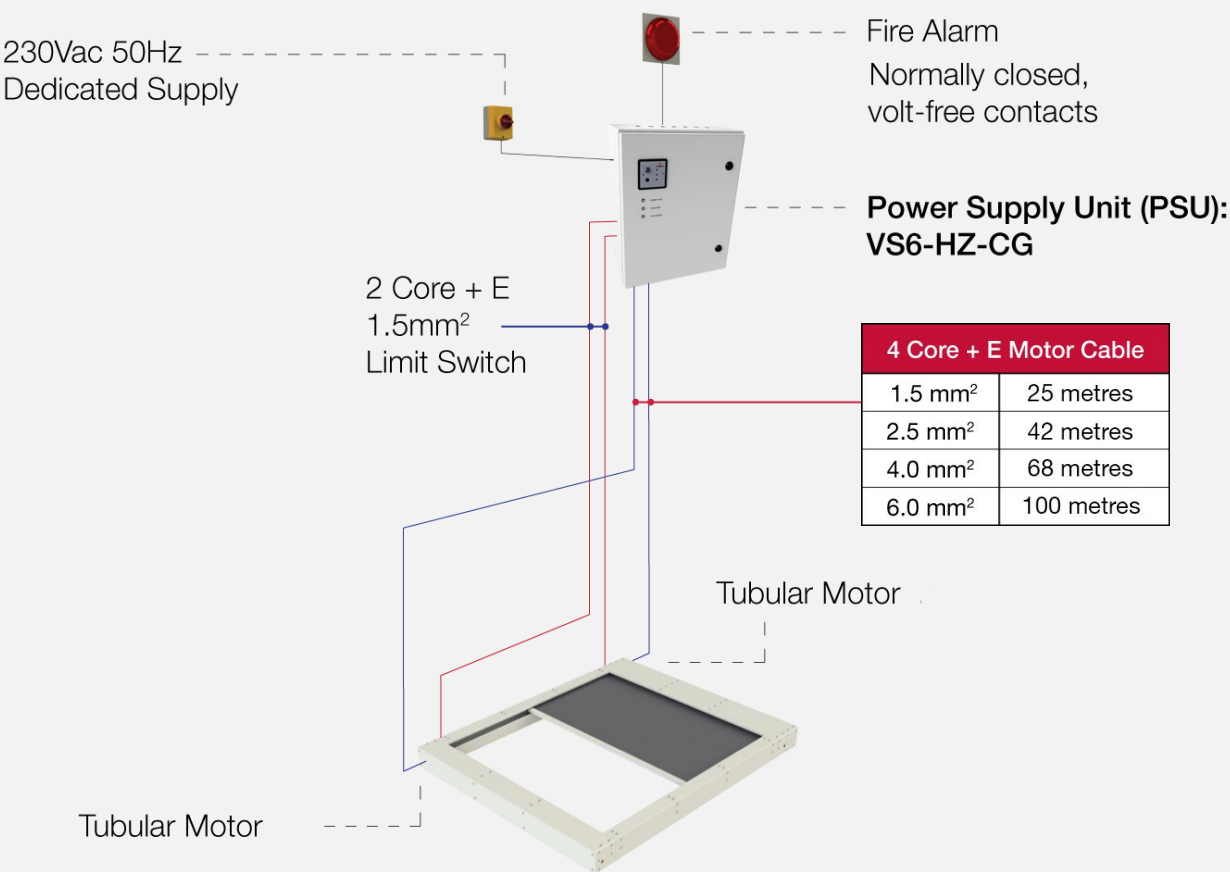

FIELD WIRING MINIMUM FP200 RATING

HORIZONTAL – CONTROLS GROUPED (HZ-CG)

VARIOSPEED®6 CONTROLS GROUPED (CG) –
TYPICAL WIRING LAYOUT FOR
DUPLEX™ (DOUBLE CURTAIN ASSEMBLY)

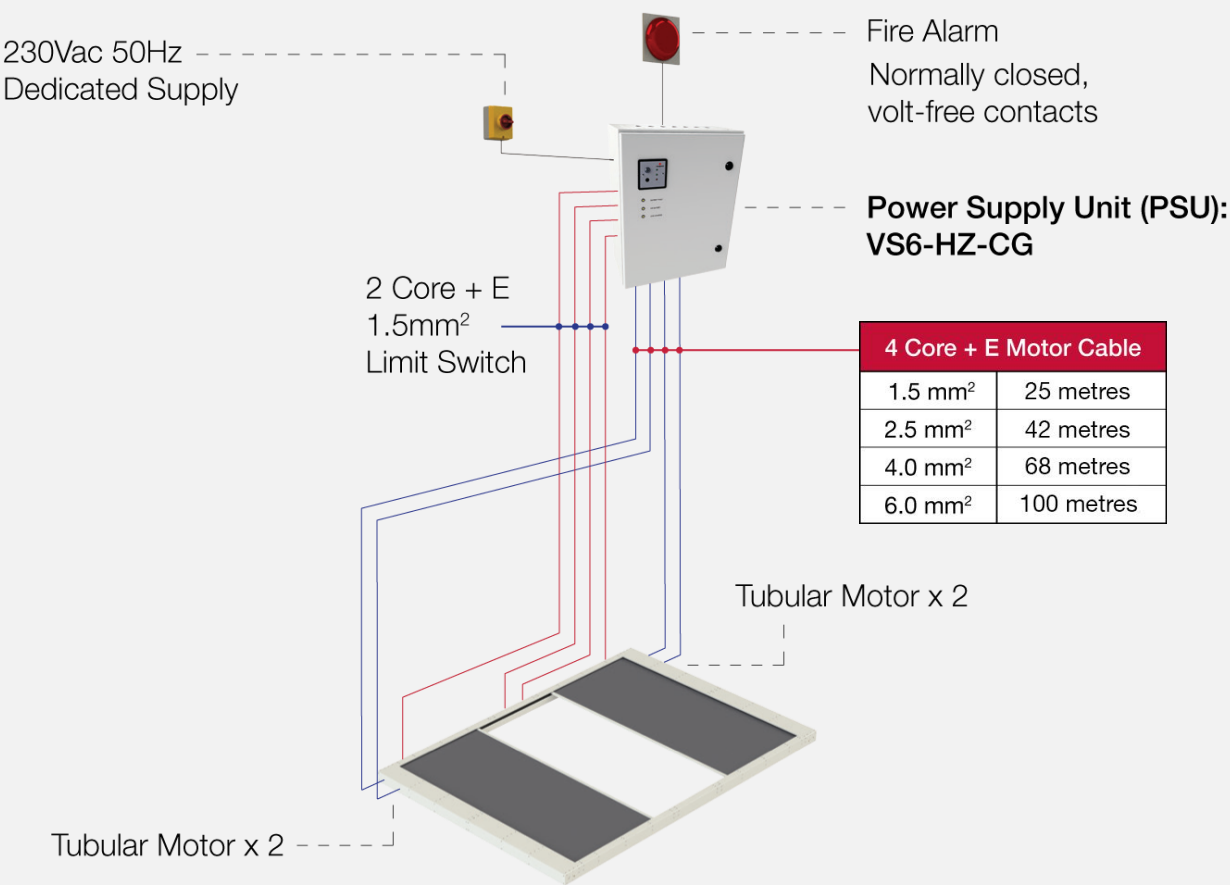

FIELD WIRING MINIMUM FP200 RATING

HORIZONTAL – CONTROLS GROUPED (HZ-CG)

CONTROLS – OPTIONAL EXTRAS MATRIX

See the table below for use of optional extras available.

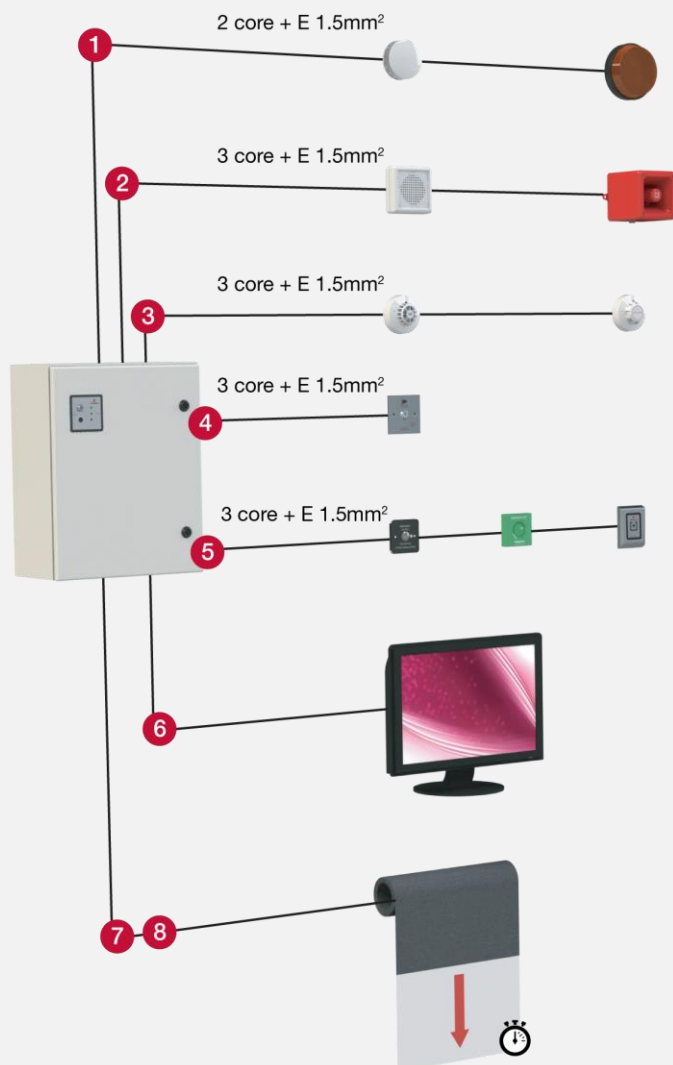

Optional Extras		Control Panel Type	
		ERU / MONO	BBU
1	Light Warning Unit	✓	✓
2	Voice Warning Unit	✓	✓
3	Heat Detector Smoke Detector	✓	✗
4	Test / Reset Switch	✓	✓
5	Emergency Retract Push Buttons	✓	✗
6	Building Management System (BMS) Interface	✓	✓
7	Adjustable Split Drop and Half Drop Enabled	✓	✗
8	Safety Edge / Bump Stop	✓	✗

Datasheet Optional Extras Reference

Visit Coopers Fire website at www.coopersfire.com



Coopers Fire Ltd
Ignis House,
Houghton Avenue,
Waterlooville, Hampshire
PO7 3DU.
United Kingdom

Phone: +44 (0)2392 454 405
Email: info@coopersfire.com
Web: www.coopersfire.com

Coopers Fire Ltd has a policy of continuous product improvement. As such we reserve the right to change design and specifications without prior notice.

Please check our website for the latest information

© Coopers Fire Ltd. All content and products are copyright of Coopers Fire Ltd. Registered in England Number: 2010274. Multiple patents granted and pending.