

HEADBOX FIXING OPTIONS

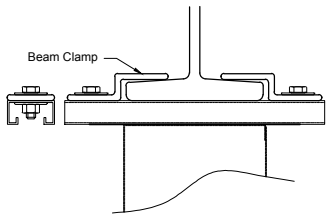

I BEAM FIXING

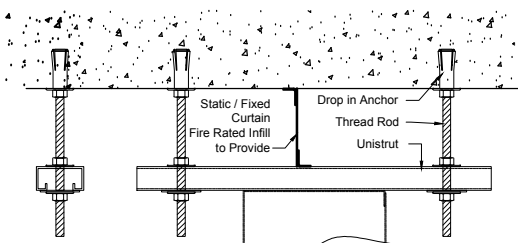

DROP ROD INTO SLAB FIXING

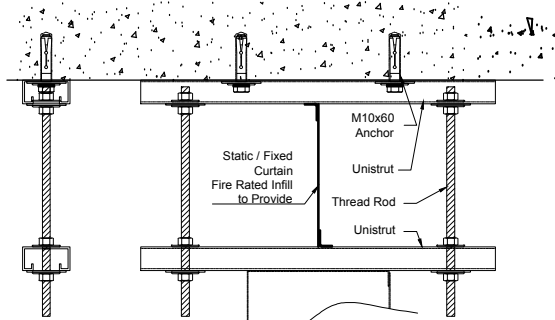

DROP ROD TO UNISTRUT FIXING

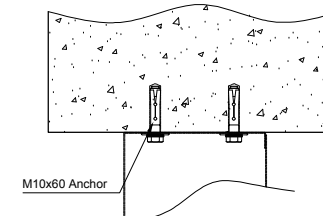

TOP DIRECT FIXING TO CONCRETE

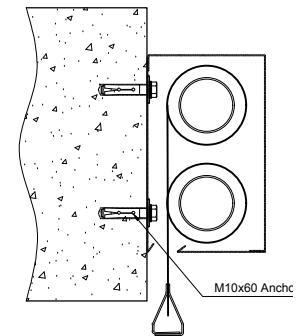

BACK DIRECT FIXING TO CONCRETE

HEADBOX ACCESS OPTIONS

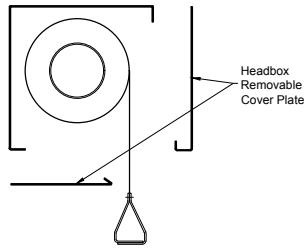

STANDARD HEADBOX

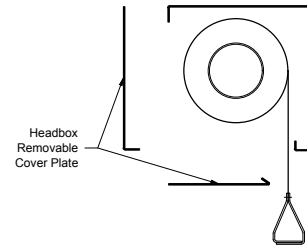

REVERSE HEADBOX

CEILING ACCESS OPTIONS

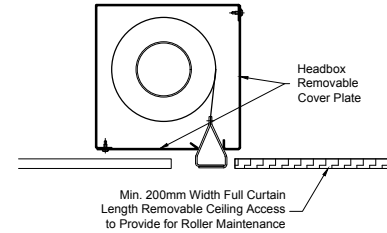

STANDARD HEADBOX

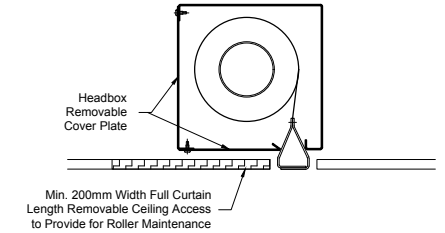

REVERSE HEADBOX

SIDE GUIDE FIXING OPTIONS

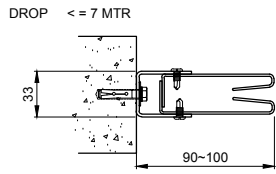

SIDE FIX

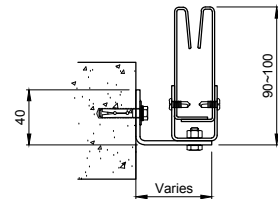

REVERSE FIX - Option 1

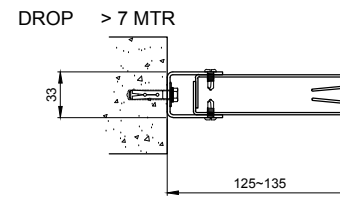
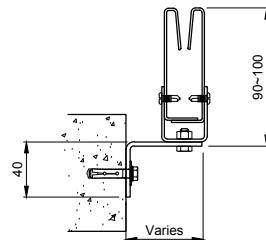

SIDE FIX

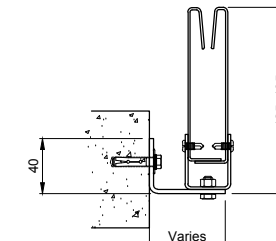

REVERSE FIX - Option 1

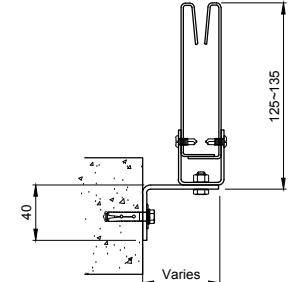

BOTTOM BARS OPTIONS

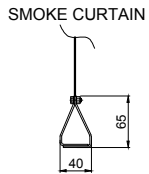

JUMBO BOTTOM BAR

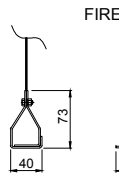

JUMBO BOTTOM BAR

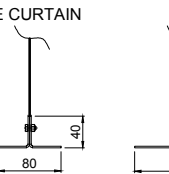

'T' BOTTOM BAR

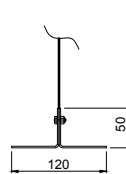

75 ACE CAPPING

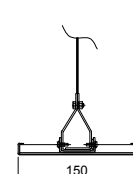

150 ACE CAPPING

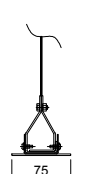

75 STALL PLATE

CEILING & BOTTOM BARS INTERFACE OPTIONS

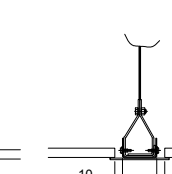
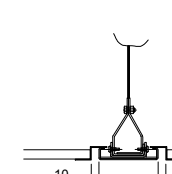
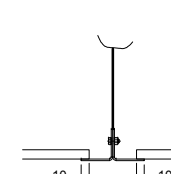
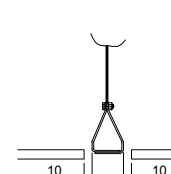

Edward House, Penner Road,
Havant, Hampshire, PO9 1QZ, UK
Tel: +44 (0)2392 454 405
Email: info@coopersfire.com
Web: www.coopersfire.com

DRAWN:	ML	TITLE:	Headbox Fixing, Headbox Ceiling Interface, Bottom Bar & Capping Variations
CHECKED:	JR	© 1997-2018 COOPERS FIRE LIMITED ALL RIGHTS RESERVED. THIS DESIGN MAY NOT BE REPRODUCED IN ANY MATERIAL FORM, INCLUDING ELECTRONICALLY WITHOUT THE WRITTEN PERMISSION OF THE COPYRIGHT NAMES	ALL DIMENSIONS IN MILLIMETRES UNLESS OTHERWISE STATED
APPROVED:	JR	DRG. No.	600/616/MK
		ISSUE:	1
		DATE:	06.09.18

* For Information Use Only
Standard Size, Standard Configuration, Sizes Greater than Stated please contact Coopers