



The Virtual, Intelligent, Invisible fire door system



www.viifire.co.uk



The Virtual, Intelligent, Invisible fire door system

You'll never know its there until you need it!

The Coopers ViiFire Door is concealed neatly away out of sight enabling you to design, change and improve the internal environment of any building requiring fire doors or separations whilst improving on safety. The ViiFire Door offers the first real alternative to conventional fire separations giving architects and owners the opportunity to open up and improve any internal space on many levels including functionality, decor and above all, life safety.

Introducing The ViiFire Door



The ViiFire Door is a neat compact fully automatic motorised roller system with a state of the art high temperature stainless steel reinforced curtain, tested up to 1000°C, concealed in a strong steel casing above your doorway or opening. It remains hidden but ready to work when you need it - in the event of fire. It is easy for a competent person to install and is the first and only 'plug and play' system.



Company Profile

Coopers Fire invented and patented the Gravity Fail Safe (GFS) Fire and Smoke Curtain, which has become the benchmark for most smoke and fire curtain systems sold today.

Coopers products have been specified and installed in most of the world's landmark buildings including Chek Lap Kok Airport - Hong Kong, Swiss Re (the Gherkin) - London, Dubai International Airport and even Wembley Stadium.

Coopers Fire have been heavily involved in the introduction of British and European Standards, including the very latest BSI PAS 121: 2007, the only definitive specification for Fire Curtains in the world.

Coopers were the first to bring Fire and Smoke Curtains to the market with micronized aluminium fire resistant coatings, now the industry standard. Also were the first to introduce the 24 V dc variable speed drive system, with integral 24 V dc brake and regenerative dynamic braking.

Now known worldwide as VarioSpeed, this very latest generation of systems, backed by over 25 years of experience, is the heart of the brand new ViiFire Door.

Coopers Fire is based in their new purpose built manufacturing plant in UK.

Why choose **Vii Fire Door**

ViiFire Door removes the hassle of doors; designing, installing, maintaining, propping open and living with the inconvenience and danger of constantly opening them. ViiFire Door improves the environment in which you live and work.

Don't compromise on safety; merely conceal it until needed, and with additional safety features like battery back-up, emergency power and controlled fail safe descent ViiFire Door will quietly and inconspicuously protect you 24 hours a day, 7 days a week leaving you with full peace of mind. The ViiFire Door can be retro-fitted and or designed and installed into new build projects creating the opportunity to rethink the design of your building internally.

Standard fire door



Vii Fire Door



Vii Fire Door During activation



Architectural Benefits

- Increases the scope of internal design possibilities
- Creates solutions for radical property development
- Maintains building fire & smoke integrity without compromise

Safety Improvements

- No risk of tripping, falling, snagging or trapping
- Removes risk of inadvertent fire regulation infringement
- Improves internal visibility, for better security
- Reduces risk of infection transfer
- Resolves issues relating to building regulations for access to and use of buildings (Approved Document M)
- Supports Government initiative of Lifetime Homes

Fit For Purpose

- Plug and Play technology
- Can be retro fit or new build installed
- Designed to operate independently
- Can be integrated into existing fire alarm system
- Reduced installation time

Commercial Benefits

- Releases chargeable floor space from communal areas to generate additional revenue
- Increase footprint flow
- Reduces Service & Maintenance 'on costs'
- Aids Point of Sale Marketing in shops and hotels

Accreditations

BS EN 1634-1:2000
BS 476-22-8:1987
BS PAS 121:2007
BS 7346-3:1990
BS 476-6:1989
BS 476-7:1997
BS 476-31.1:1983

ISO 9001:2000

Meets the 'self closing without power' fire safety requirement (Approved Document B)

ViiFire Door reduces the risk of bacterial infection and dirt transfer in heavy traffic areas.



ViiFire Door's range of standard opening sizes accommodates most building needs however if you have a need for something special, a made-to-measure service is available. This will give you the opportunity to create a clear opening for corridors and communal areas. For installation, use Coopers trained approved ViiFire Installers, adding value to the overall package and your peace of mind.

ViiFire Door's wide range of safety accessories and upgrades are available to comply with the Building Regulations requirements. ViiFire Door will also give solutions where Building Regulation, Approved Documents B and M (England & Wales only) clash, where the demands of 'fire safety' conflict with 'access to and use of buildings'.

Made to Measure

Outside of the standard sizes, ViiFire Doors are available in bespoke sizes from a minimum width of 900mm up to a maximum overall clear opening size of 3000 x 3000 (mm).

Lead times for these bespoke sizes as well as non-standard colours are agreed at order confirmation.

General Testing & Fire Test (demand all, not just part testing or you are at risk)

Demand full proof of fire rating and testing. If you use the wrong product or compromise on testing you risk lives, you risk your insurance, you risk corporate or personal manslaughter and Building Control will require you to remove non-compliant systems and replace them with compliant ones.

ViiFire Door is tested for (i) Fire Resistance (ii) Total Gravity Fail Safe (iii) Smoke Control Door (do not be fooled by suppliers claiming the lesser smoke curtain performance) (iv) Reliability and (v) Insulating Zone (see 'Accreditations') and is therefore a fully tested and 'Fit for Purpose' product

Fire Resistance

ViiFire has been fully tested for a full 2 hr Fire Resistance Integrity to both British and British / European Standards

Total Gravity Fail to Safe

As a requirement of BS PAS 121:2007, in the event of mains power loss, total battery backup consumption and or system / wiring corruption, the ViiFire Door will fail to safe to a closed position with controlled descent. Mains power loss will be indicated by warning buzzer

Reliability / Cyclic Testing

Your curtain will not be much good if it stops working after a short time. ViiFire products have been tested for 700 cycles . C1 Classification

Smoke Control Door / Smoke Seal Performance

Your ViiFire Door can be supplied, tested and compliant, to BS 476-31-1 as required by Approved Document B (ADB) 2006 for smoke seal.

Insulating Zone

ViiFire Door can also offer Insulating Zone performance with the use of ViiFire i-Zone fabric. This performance is required by BS PAS 121:2007 for such applications as protecting Means of Escape and achieves radiated heat as low as 6 kW/m² after 60 minutes.

Alarm Integration

The ViiFire Door can stand alone with its own dedicated smoke, heat or thermal fuse detectors or it can be integrated in to the main alarm system.

Door Sizes

When Face Fixing around clear openings:

When a ViiFire Door is face fixed around the reveal, consideration has to be given to the overall unit size being greater than the clear opening size required. This is to the effect of 190mm in height and 170mm in width.

When Reveal Fitting inside clear openings:

When the ViiFire Door is fitted within the reveal, consideration has to be given that the overall unit size becomes the clear opening size. Therefore the resultant clear opening size arrived at after installation is reduced by 170mm in width and 160mm in height.

Please state whether you require Face Fixing or Reveal Fixing when placing an order.

Standard Sizes Available

Clear Opening Widths (mm):

- 900
- 1000
- 1200
- 1500
- 2000
- 2500
- 3000

Clear Opening Heights (mm):

- 2000
- 2100
- 2300
- 2500
- 3000

See technical brochure for weights and unit sizes.

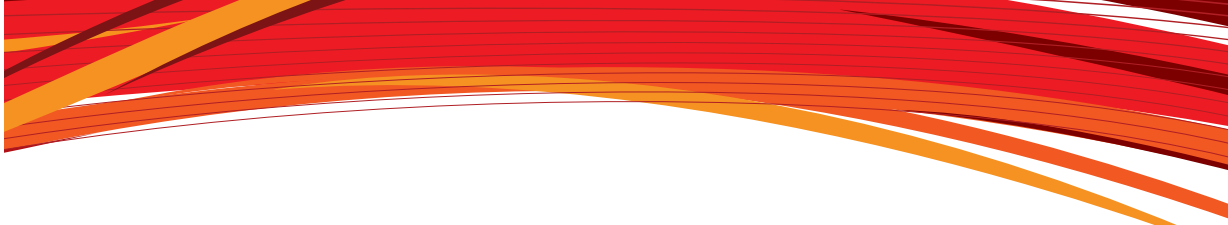

ViiFire Door improves light and air circulation in areas otherwise requiring additional lighting and air conditioning

Typical ViiFire Door System*

ViiFire Door is independently operational off the shelf, but has the facility to be fully integrated in to any alarm system. (Screws and cables included.)



Power Supply Unit



ViiFire Control



Smoke detector



Commercial retract button



Battery backup

System Options

Optional accessories are available to enhance and improve your ViiFire Door and offer a full comprehensive solution to the demands of legislation and Building Control. Bump Stop, Obstruction Detector and Split Drop Delay are also available. These options are always accompanied by either the Audio / Visual Beacon or the Voice Warning unit.



Voice warning



Audio / Visual beacon



Heat sensor



Smoke detector



Commercial retract button



Residential retract button



Touch sensitive retract button

Colour Options

The standard ViiFire Door finish is Zintec coating. The Zintec coating can be painted with any interior paint to match the surrounding decor. The ViiFire Door is also available in Stainless Steel (Grade 316) and RAL 9010 however we can accommodate any listed RAL colour for an additional charge.

Fixing Options

Face Fixed

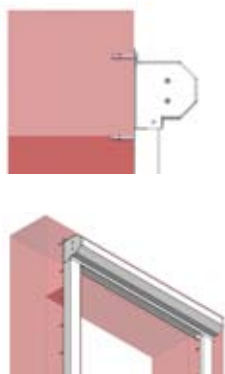
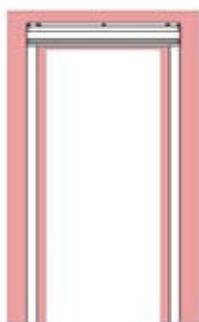

Reveal Fixed

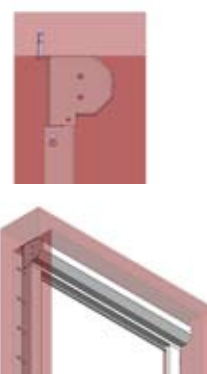
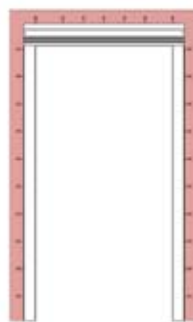

*The Typical ViiFire Door System shown is of a specification featuring smoke detectors and commercial (public building) push to retract buttons. Alternatively you can choose the ViiFire Door basic system Power Supply Unit & ViiFire Control only, and also include any of the system options available.

FAQ's

1) **Q) Is the ViiFire Door covered by warranty?**

A) The ViiFire Door is covered by a standard 12 month (return to factory) warranty. Additional comprehensive 12 and 24 month on site cover is available (see price list) Contact ViiFire Maintain on +44 (0)2392 454405. Ext. 250 for details.

2) **Q) What are ViiFire Door's Warranties and Guarantees worth?**

A) All ViiFire Door's Warranties and Guarantees are supported by Coopers Fire Ltd. In addition Coopers has Public and Product liability of £10 million and Professional Indemnity of £5 million.

3) **Q) What maintenance does the ViiFire Door require?**

A) It is a legal requirement to regularly maintain all fire rated equipment. As the ViiFire Door is part of a life safety system and is connected to a fire alarm system there is an obligation under the Regulatory Reform (Fire Safety) Order 2005 to ensure testing is performed in accordance with BS5588-12. For details of our service and maintenance options contact ViiFire Maintain on +44 (0)2392 454405 Ext. 250.

4) **Q) How do I know when I need to replace the batteries and how long do they last?**

A) The standard manufacturers' warranty for batteries is 12 months, however they can last much longer. Batteries should be regularly checked on maintenance visits. The ViiFire Door will always default to its fire operational position in the event of battery failure, which is safe – but maybe inconvenient!. Instructions for maintenance are included however ViiFire Maintain also offer this service. For further details please contact ViiFire Maintain on +44 (0)2392 454405 Ext. 250.

5) **Q) Can I mount the side guides inside a reveal as well as on the face of an aperture?**

A) Yes, the ViiFire Door is now available to be reveal fixed as well as face fixed - please contact ViiFire Technical for further advice on +44 (0)2392 454405 Ext. 248.

6) **Q) What happens if I have a mains power cut?**

A) Provided the unit is correctly installed following the fitting and installation instructions, the ViiFire Door will remain retracted for 30 minutes and then descend under Gravity Failsafe - or immediately following an alarm signal.

7) **Q) Is the ViiFire Door easy to connect - what do I need to provide?**

A) The ViiFire Door fire curtain unit is fully 'Plug and Play'. All cables are provided with snap connectors and power is via a standard factory fitted 230Vac 13A plug which must be connected to a dedicated supply. During this 30 minute period, the ViiFire Door can still be operated for a limited time (depending on the number of operations).

8) **Q) Do you provide an installation service?**

A) Yes - Installation can be provided by a Coopers Approved ViiFire Installer at a reasonable additional cost, please contact ViiFire Install on +44 (0)2392 454405 Ext. 226.

9) **Q) Can the unit be boxed in to blend in with my existing decor?**

A) Yes - providing any exterior surround should not impair the normal function of the ViiFire Door. Any custom made surround should be suitably fire rated - equivalent to the compartment and the product. For further details you should seek assistance from your local Building Surveyor at your local Building Control office. Consideration should also be made to access requirements for future maintenance.

10) **Q) Can the ViiFire Door be used in a domestic or residential environment?**

A) Yes - the ViiFire Door is a compact, lightweight and easy-to-fit unit, ideal for use in the home. Remember that all buildings outside of dwelling houses will be under the Regulatory Reform (Fire Safety) Order 2005. It would be advisable to check with your local Building Control Office.

11) **Q) Can I have my ViiFire Door unit in any colour?**

A) The standard finish is RAL white (9010) - other colours are available at additional cost (including (grade 316) stainless steel). We also offer Zintec coating (subject to availability) which allows for painting with emulsion paint to match the surrounding decor.

12) **Q) How will my ViiFire Door be delivered?**

A) In a special ViiFire Door branded box, complete with fittings, instructions etc.

13) **Q) How heavy is my ViiFire Door**

A) Normally you will need 2 people to lift and install a ViiFire Door safely. Refer to the chart for weights. Care should always be taken to refer to the Health and Safety Guidelines with regards to lifting.

14) **Q) How do I order a ViiFire Door?**

A) By visiting www.viifire.co.uk or by contacting ViiFire Sales on 0800 783 6628

* ViiFire Door is fitted to the Spinnaker Tower, Portsmouth



Improve your view with ViiFire Door*



Assessed to ISO 9001:2000
Certificate number FM22356



**Coopers
Fire**

Coopers Fire Ltd, Edward House, Penner Road, Havant, Hampshire, PO9 1QZ United Kingdom.
Tel: +44(0) 23 9245 4405 Fax: +44 (0) 23 9249 2732
email: info@coopersfire.com web: www.coopersfire.com

The Company reserves the right to change product specifications that incorporate any improvements and upgrades to both electrical and mechanical components without prior notification

Coopers Fire Ltd have 30 years of Fire Life Safety experience which is supported by Public and Product liability of £10 million and Professional Indemnity of £5 million.