

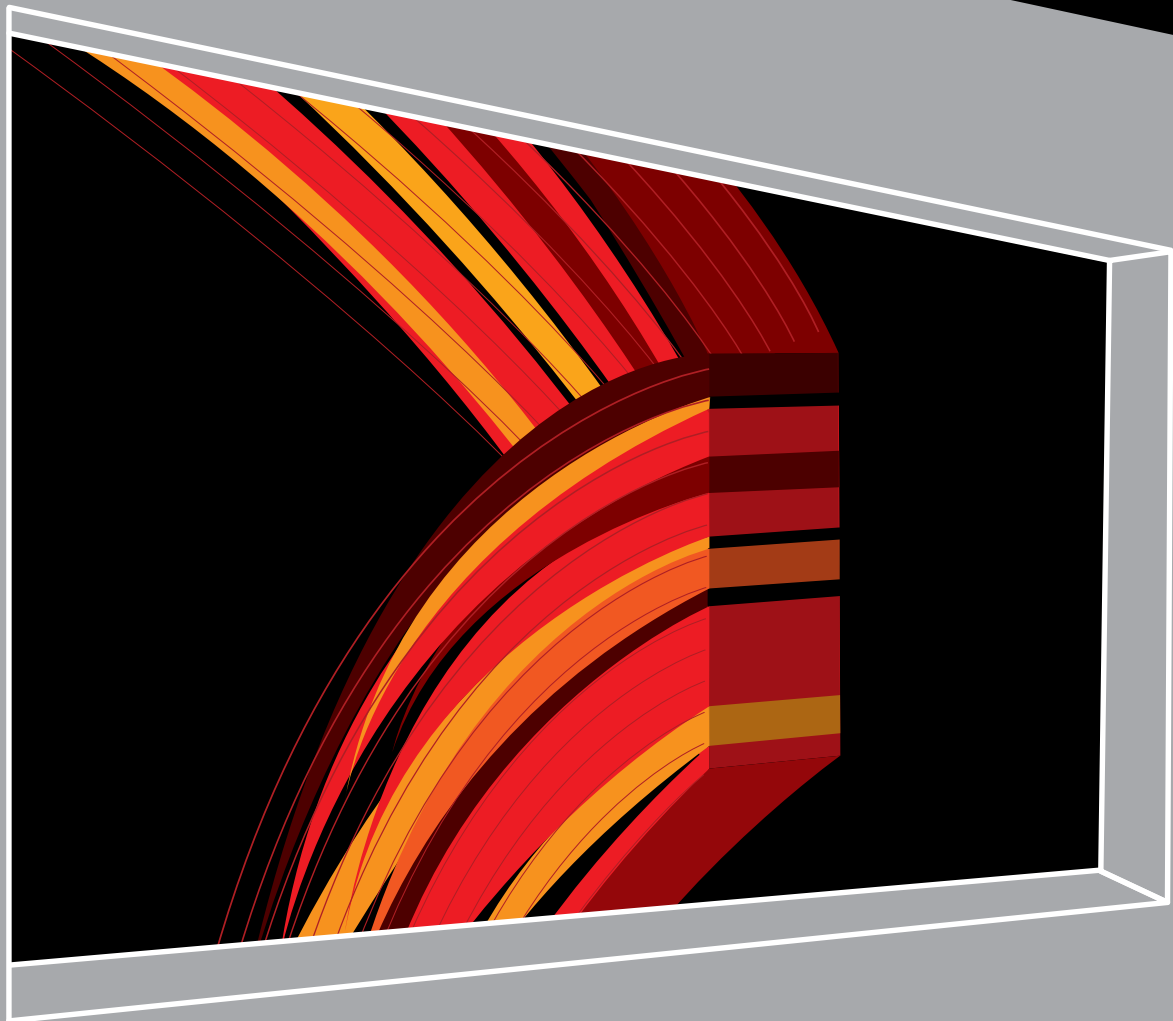

The Virtual, Intelligent, Invisible server fire protection system



Why choose **ViiFire** Serve

The ViiFire Serve removes the hassle of designing, installing and maintaining fire shutters or the need for restrictive partitioning. It also removes the inconvenience, expense and danger of traditional methods of fire separation. The ViiFire Serve improves the environment in which you live and work.

Don't compromise on safety; merely conceal it until needed, and with additional safety features like battery back-up, emergency power and controlled fail safe descent ViiFire Serve will quietly and inconspicuously protect you 24 hours a day, 7 days a week leaving you with full peace of mind. The ViiFire Serve can be retro-fitted and or designed and installed into new build projects creating the opportunity to rethink the design of your building internally.

Standard shutter - closed

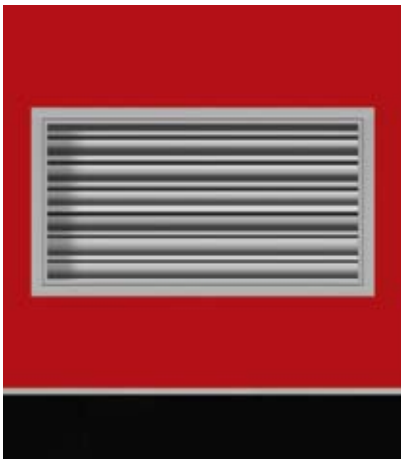

Standard shutter - open



ViiFire Serve



Architectural Benefits

- Increase the scope of internal design possibilities
- Creates solutions for cost effective radical property development
- Maintains building fire & smoke integrity without compromising décor

Fit For Purpose

- Can be retro fit or new build installed
- The only 'Plug and Play' system removes the need for electricians
- Designed to operate independently
- Can be integrated into existing fire alarm systems
- Reduced installation time

Commercial Benefits

- Release additional chargeable floor space
- Reduces long term service and maintenance costs

Accreditations

BS EN 1634-1:2000
BS EN 12605:2000
BS EN 1634-3:2004
BS 476-22-8:1987
BS PAS 121:2007
BS 7346-3:1990
BS 476-6:1989
BS 476-7:1997
ISO 9001:2008

Meets the 'self closing without power' fire safety requirement (Approved Document B)

ViiFire Serve allows for radical design without compromising on fire safety.





The Virtual, Intelligent, Invisible servery fire protection system

You'll never know its there until you need it!

The Coopers ViiFire Serve can be concealed neatly away out of sight or installed to create a low profile. This makes changes and improvements available to the internal environment of any building requiring fire separation or protection whilst improving on safety.

The ViiFire Serve offers the first real alternative to conventional fire separation i.e. steel shutters, fire rated glazing and stud partitioning. This gives architects and owners the opportunity to open up and improve internal space on many levels including functionality, décor and above all LIFE SAFETY.

Introducing The ViiFire Serve



The ViiFire Serve is a neat, compact, fully automatic motorised system with a state of the art, high temperature stainless steel curtain. It is tested up to 1000 °C and is concealed in a strong steel casing that can be installed above your clear opening or reveal fitted inside it. It remains hidden but ready to work when you need it; in the event of a fire. It is easy for a competent person to install and is the first and only 'plug and play' system of its kind.



Company Profile

Coopers invented and patented, the Gravity Fail Safe (GFS) Smoke and Fire Curtain, which has become the benchmark for most smoke and fire curtain systems sold today.

Coopers products have been specified and installed in most of the world's landmark buildings, Chek Lap Kok Airport, Hong Kong, Swiss Re (the Gherkin) London, Dubai International Airport and even Buckingham Palace.

Coopers have been heavily involved in the introduction of British and European Standards, including the very latest BSI PAS 121, the only definitive specification for Fire Curtains in the world.

Coopers were the first to bring Smoke and Fire Curtains to the market with micronized aluminium fire resistant coatings now the industry standard and the first to introduce the 24 v dc variable speed drive system, with integral 24 v dc brake and regenerative dynamic braking. Now known, worldwide, as VarioSpeed, this very latest generation of systems, backed by over 25 years of experience, is the heart of the brand new ViiFire Serve. Coopers Fire is based in their new state of the art manufacturing plant in UK.



The ViiFire Serve's range of standard clear opening sizes accommodate most building needs however; if you have a need for something bespoke, there is a 'made to measure' service available. This will give you the opportunity to create a clear opening for serverys, receptions, sales counters, restaurant partitioning and protecting non fire-rated glazing adjacent to a means of escape.

For added peace of mind, Coopers have a network of approved, trained and experienced ViiFire Installers available. Also there are a wide range of safety accessories and upgrades available to comply with Building Control regulation requirements, which add value to the overall package.

Made to Measure

Outside of the standard sizes, ViiFire Serves are available in bespoke sizes from a minimum width of 900mm up to a maximum clear opening size of 3000 x 3000 (mm).

Lead times for these bespoke sizes as well as non-standard colours are agreed at order confirmation.

General Testing & Fire Test

(demand all, not just part testing or you are at risk)

Demand full proof of fire rating and testing. If you use the wrong product or compromise on testing you risk lives, you risk your insurance, you risk corporate or personal manslaughter and Building Control will require you to remove non-compliant systems and replace them with compliant systems.

ViiFire Serve is tested for (i) Fire Resistance (ii) Total Gravity Fail Safe (iii) Smoke Control Barrier (do not be fooled by suppliers claiming the lesser smoke curtain performance) (iv) Reliability and (v) Insulating Zone (see 'Accreditations') and is therefore a fully tested and 'Fit for Purpose' product.

Fire Resistance

ViiFire has been fully tested for a full 2 hr Fire Resistance Integrity to both British and British / European Standards.

Total Gravity Fail to Safe

As a requirement of BS PAS 121:2007, in the event of mains power loss, total battery backup consumption and or system / wiring corruption, the ViiFire Serve will fail to safe to a closed position with controlled descent. Mains power loss will be indicated by warning buzzer.

Reliability / Cyclic Testing

Your curtain will not be much good if it stops working after a short time. ViiFire products have been tested for 700 cycles. C1 Classification.

Smoke Control Serve / Smoke Seal Performance

Your ViiFire Serve can be supplied compliant to Approved Document B (ADB) 2006 for smoke seal when tested to BS EN 1634-3:2004.

Insulating Zone

ViiFire Serve can also offer Insulating Zone performance with the use of ViiFire i-Zone fabric. This performance is required by BS PAS 121:2007 for such applications as protecting Means of Escape and achieves radiated heat as low as 6 kW/m² after 60 minutes.

Alarm Integration

The ViiFire Serve can be stand alone with its own dedicated smoke, heat or thermal fuse detectors or it can be integrated in to the main alarm system.

Serve Sizes

When Face Fixing around clear openings:

When a ViiFire Serve is face fixed around the reveal, consideration has to be given to the overall unit size being greater than the clear opening size required. This is to the effect of 190mm in height and 170mm in width.

When Reveal Fitting inside clear openings:

When the ViiFire Serve is fitted within the reveal, consideration has to be given that the overall unit size becomes the clear opening size. Therefore the resultant clear opening size arrived at after installation is reduced by 170mm in width and 160mm in height.

Please state whether you require Face Fixing or Reveal Fixing when placing an order.

Typical ViiFire Serve System*

ViiFire Serve is independently operational off the shelf, but has the facility to be fully integrated in to any alarm system. (Screws and cables included.)



Power Supply Unit



ViiFire Control



Smoke detector



Battery backup

System Options

Optional accessories are available to enhance and improve your ViiFire Serve and offer a full comprehensive solution to the demands of legislation and Building Control. Bump Stop, Obstruction Detector and Split Drop Delay are also available. These options are always accompanied by either the Audio / Visual Beacon or the Voice Warning unit.



Voice warning



Audio / Visual beacon



Heat sensor



Smoke detector

Colour Options

The standard ViiFire Serve finish is Zintec coating. The Zintec coating can be painted with any interior paint to match the surrounding decor. The ViiFire Serve is also available in Stainless Steel (Grade 316) and RAL 9010 powder coat however we can accommodate any listed RAL colour for an additional charge.

Fixing Options

Face Fixed

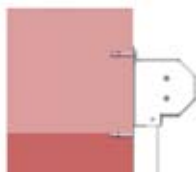
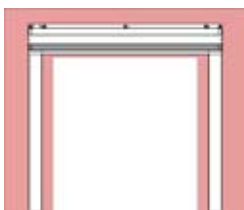

Reveal Fixed

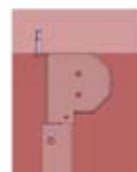
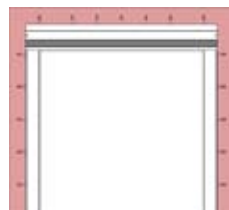

*The Typical ViiFire Serve System shown is of a specification featuring smoke detectors and commercial (public building) push to retract buttons. Alternatively you can choose the ViiFire Serve basic system Power Supply Unit & ViiFire Control only, and also include any of the system options available.

ViiFire Serve maximises the available space in cafes and canteens improving revenue.

FAQ's

- 1) **Q) Is the ViiFire Serve covered by warranty?**
A) The ViiFire Serve is covered by a standard 12 month (return to factory) warranty. Additional comprehensive 12 and 24 month on site cover is available (see price list) Contact ViiFire Maintain on 0800 783 6628 for details.
- 2) **Q) What are ViiFire Serve's Warranties and Guarantees worth?**
A) All ViiFire Serve's Warranties and Guarantees are supported by Coopers Fire Ltd. In addition Coopers has Public and Product liability of £10 million and Professional Indemnity of £5 million.
- 3) **Q) What maintenance does the ViiFire Serve require?**
A) It is a legal requirement to regularly maintain all fire rated equipment. As the ViiFire Serve is part of a life safety system and is connected to a fire alarm system there is an obligation under the Regulatory Reform (Fire Safety) Order 2005 to ensure testing is performed in accordance with BS5588-12. For details of our service and maintenance options contact ViiFire Maintain on 0800 783 6628.
- 4) **Q) How do I know when I need to replace the batteries and how long do they last?**
A) The standard manufacturers' warranty for batteries is 12 months, however they can last much longer. Batteries should be regularly checked on maintenance visits. The ViiFire Serve will always default to its fire operational position in the event of battery failure, which is safe – but maybe inconvenient!. Instructions for maintenance are included however ViiFire Maintain also offer this service. For further details please contact ViiFire Maintain on 0800 783 6628.
- 5) **Q) Can I mount the side guides inside a reveal as well as on the face of an aperture?**
A) The standard ViiFire Serve is designed to be face-fixed to an aperture. Coopers can offer alternative models if required - please contact the ViiFire Technical Department for further advice on 0800 783 6628.
- 6) **Q) What happens if I have a mains power cut?**
A) Provided the unit is correctly installed following the fitting and installation instructions, the ViiFire Serve will remain retracted for 30 minutes and then descend under Gravity Failsafe - or immediately if there is an alarm signal. During this 30 minute period, the ViiFire Serve can still be operated up and down for at least 10 operations.
- 7) **Q) Is the ViiFire Serve easy to connect - what do I need to provide?**
A) The ViiFire Serve fire curtain unit is a simple 'Plug and Play'. All cables are provided with snap connectors and power is via a standard factory fitted 230Vac 13A plug which must be connected to a dedicated supply. This dedicated socket should be fitted by your qualified electrician.
- 8) **Q) Do you provide an installation service?**
A) Yes - Installation can be provided by a Coopers Approved ViiFire Installer at a reasonable additional cost, please contact ViiFire Install on 0800 783 6628.
- 9) **Q) Can the unit be boxed in to blend in with my existing decor?**
A) Yes - providing any exterior surround should not impair the normal function of the ViiFire Serve and you can access the system for service and maintenance. Any custom made surround should be suitably fire rated - equivalent to the compartment and the product. For further details you should seek assistance from your local Building Surveyor or your local Building Control Office.
- 10) **Q) Can the ViiFire Serve be used in a domestic or residential environment?**
A) Yes - the ViiFire Serve is a compact, lightweight and easy-to-fit unit, ideal for use in the home. Remember that all buildings outside of dwelling houses will be under the Regulatory Reform (Fire Safety) Order 2005. It would be advisable to check with your local Building Control Office.
- 11) **Q) Can I have my ViiFire Serve unit in any colour?**
A) The standard ViiFire Serve finish is Zintec coating. The Zintec coating can be painted with any interior paint to match the surrounding decor. The ViiFire Serve is also available in Stainless Steel (Grade 316) and RAL 9010 powder coat, however we can accommodate any listed RAL colour for an additional charge.
- 12) **Q) How will my ViiFire Serve be delivered?**
A) In a special ViiFire Serve branded box, complete with fittings, instructions etc.
- 13) **Q) How heavy is my ViiFire Serve**
A) Normally you will need 2 people to lift and install a ViiFire Serve safely. Refer to the chart for weights. Care should always be taken to refer to the Health and Safety Guidelines with regards to lifting.
- 14) **Q) How do I order a ViiFire Serve?**
A) By visiting www.Viifire.co.uk or by contacting ViiFire Sales at Coopers on 0800 783 6628.



ViiFire Serve protects reception areas without spoiling the welcome.

**Coopers
Fire**

Coopers Fire Ltd, Edward House, Penner Road, Havant, Hampshire PO9 1QZ UK | Registered in England Number: 2010274

Phone: +44(0) 23 9245 4405 | Fax: +44(0) 23 9249 2732 | Email: info@coopersfire.com | Web: www.coopersfire.com



Assessed to ISO 9001:2008
FM 22356

Assessed to ISO 9001:2008
Certificate number: 538